

Wall Mount Instructions Millennium Falcon – (75389, 75257 & 75105)

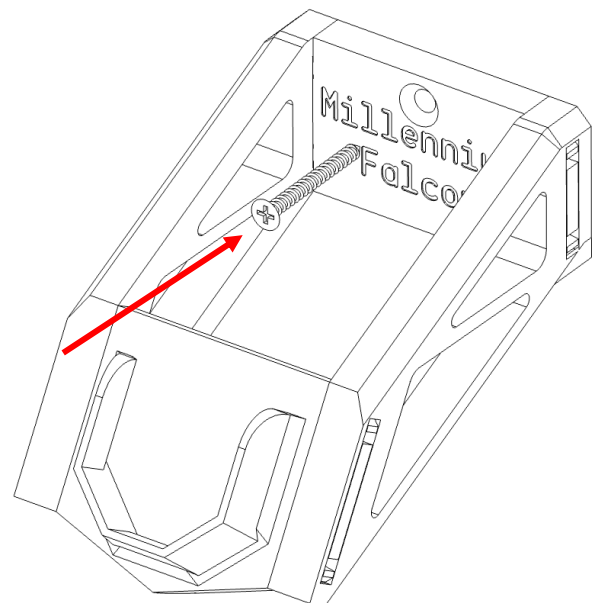

Wall Mount Instructions Millennium Falcon – (75389, 75257 & 75105)

s (Dark Falcon)

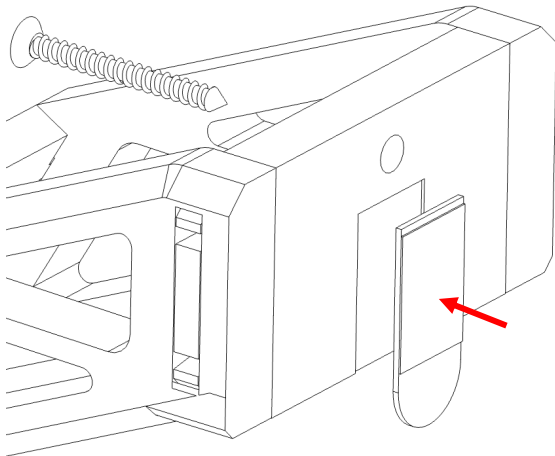
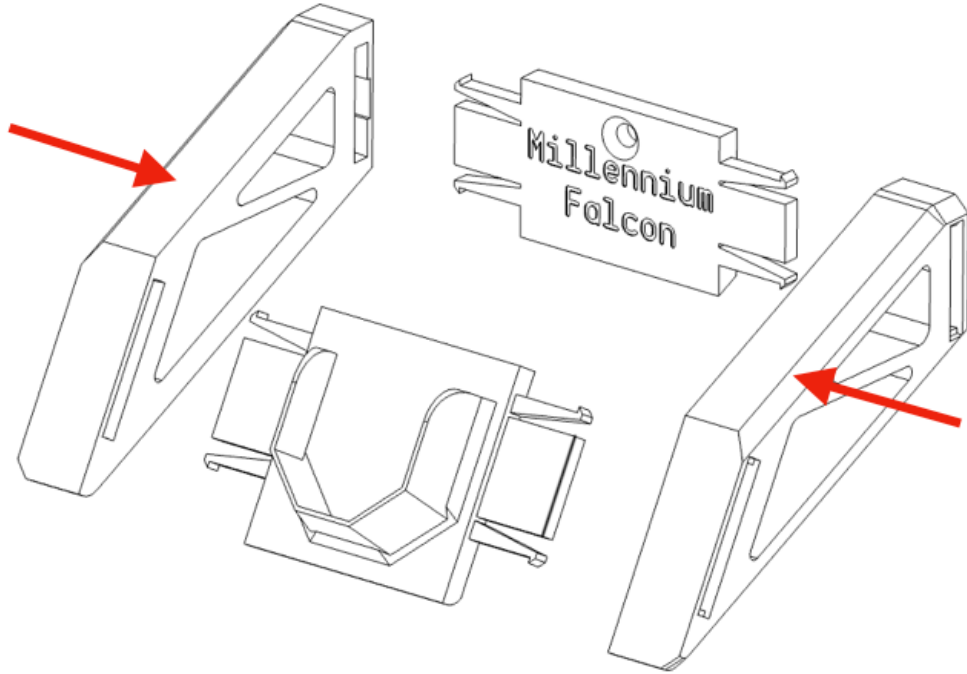
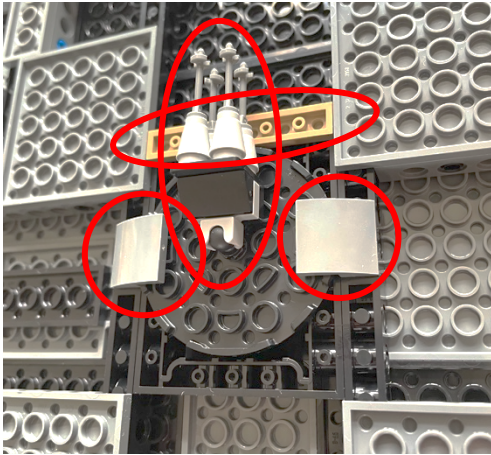

Remove the parts shown

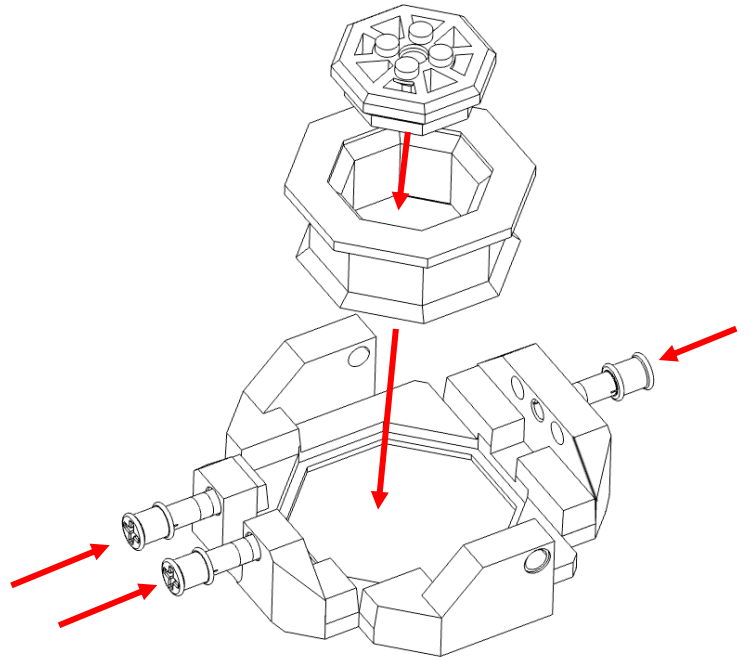

Assemble as shown. Add the three included technic push pins as shown

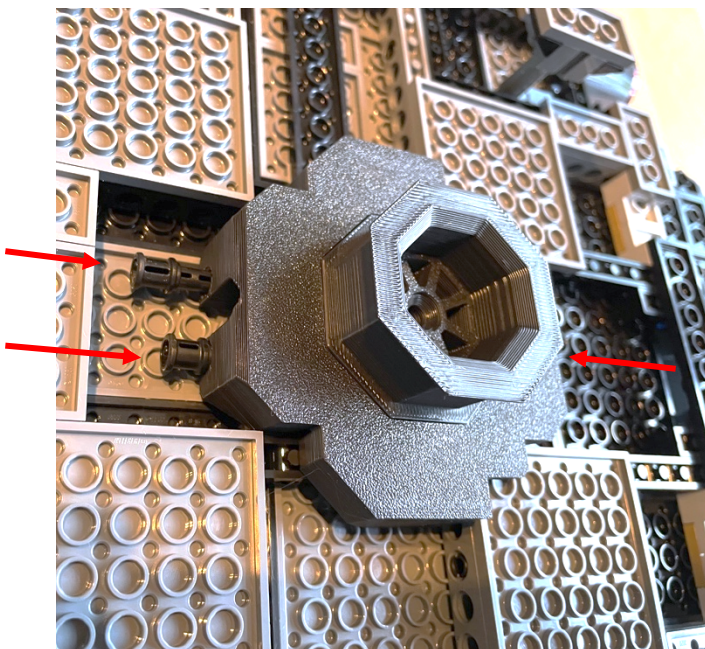

Place the adaptor this way around and then push the pins into the frame.

Wall Mount Instructions Millennium Falcon – (75389, 75257 & 75105)

75257 Instructions

Insert the first adaptor piece into the centre of the underside of the ship. Note you will need to remove the turret and ball joint element for the 75257 falcon variant. *Technic pin from the spare 75257 pieces.

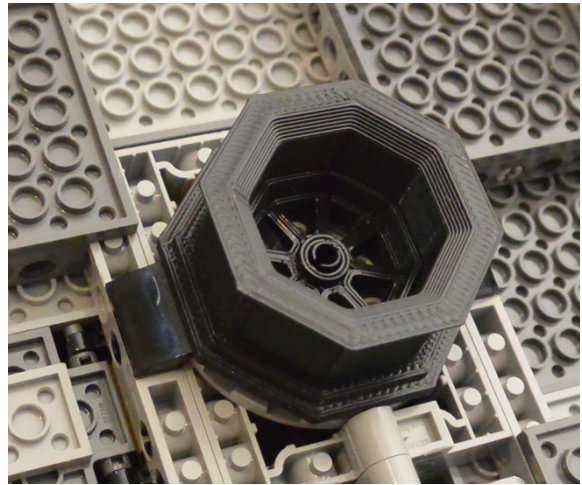
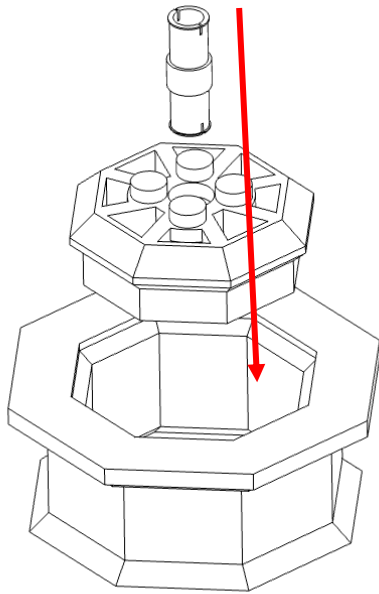

Next you will need to remove the Escape pod as shown.

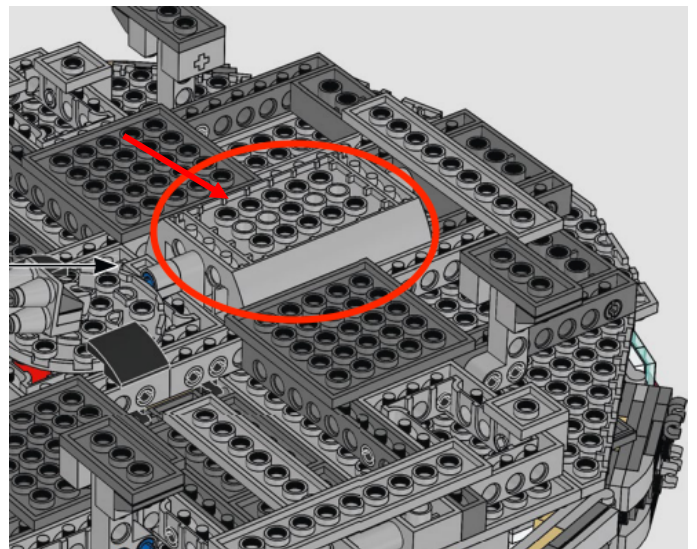
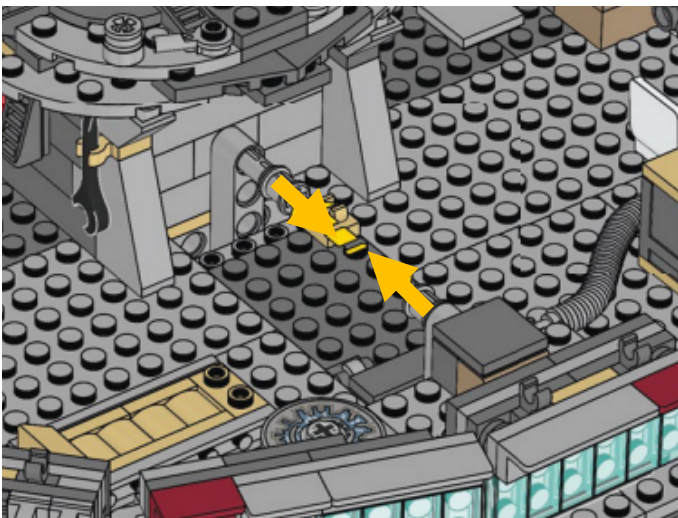

Wall Mount Instructions Millennium Falcon – (75389, 75257 & 75105)

shown in red.

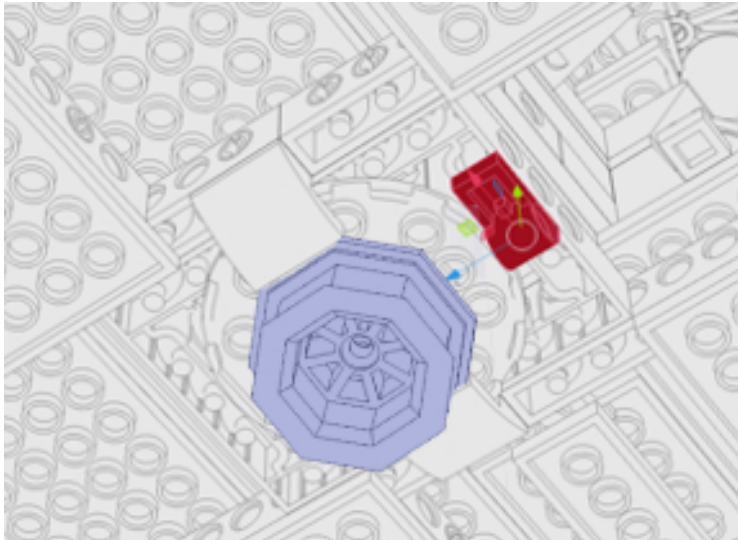

Place the second adaptor over the first and lock in place using the included Technic pins.

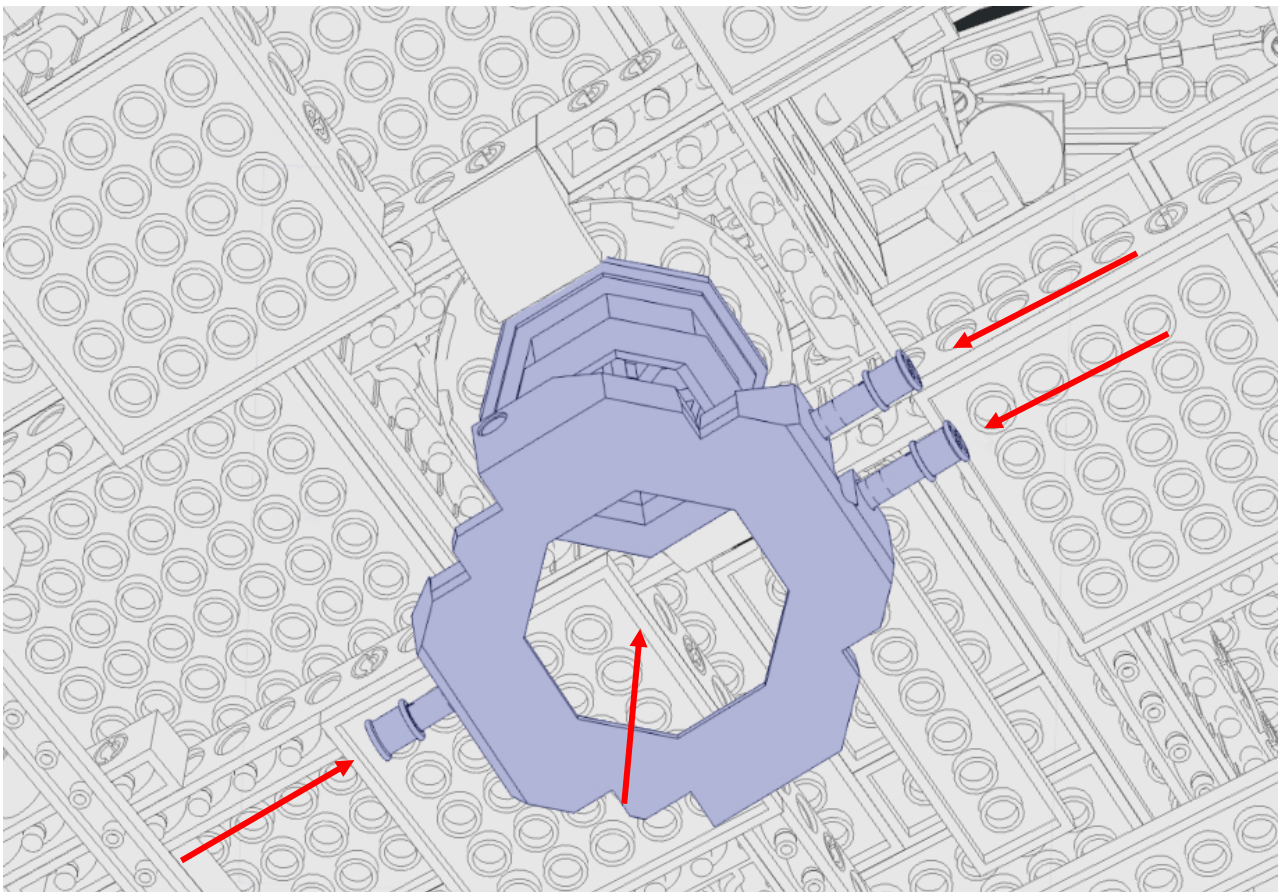

Wall Mount Instructions Millennium Falcon – (75389, 75257 & 75105)

Remove these pieces from the bottom of your set

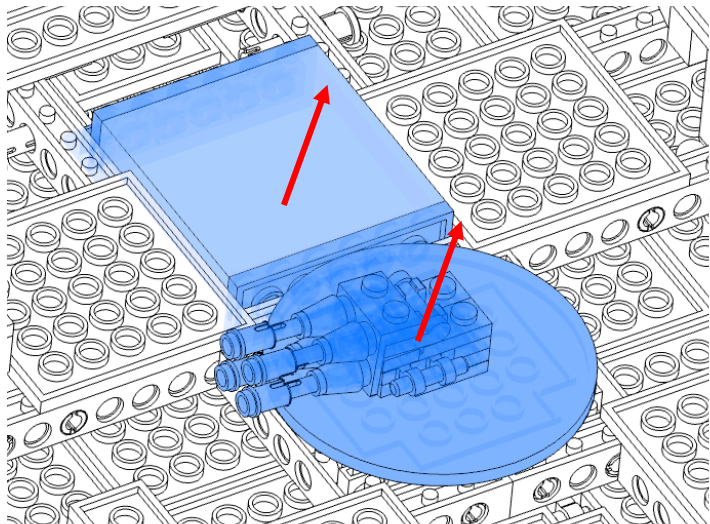

Then re-attach the 2x6 plate as shown

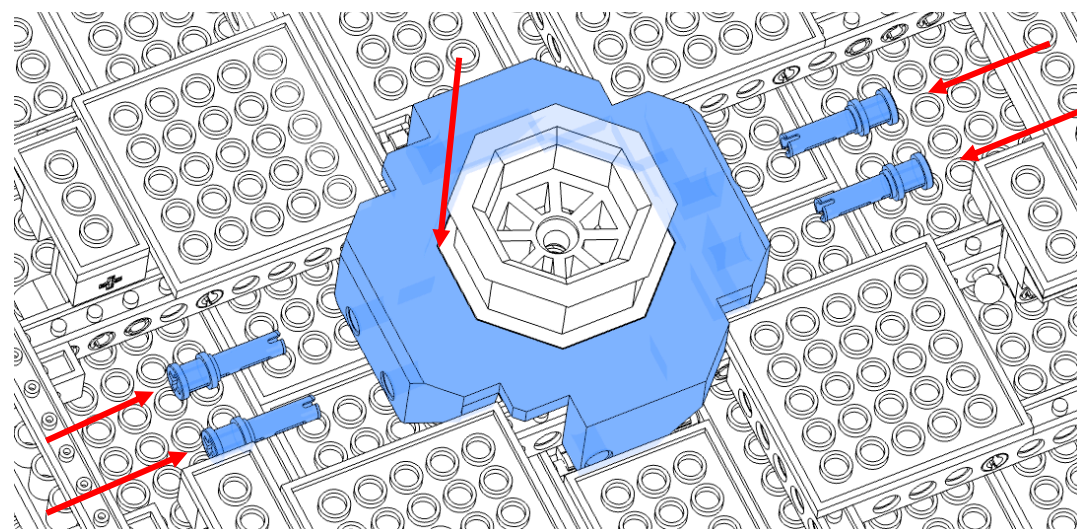
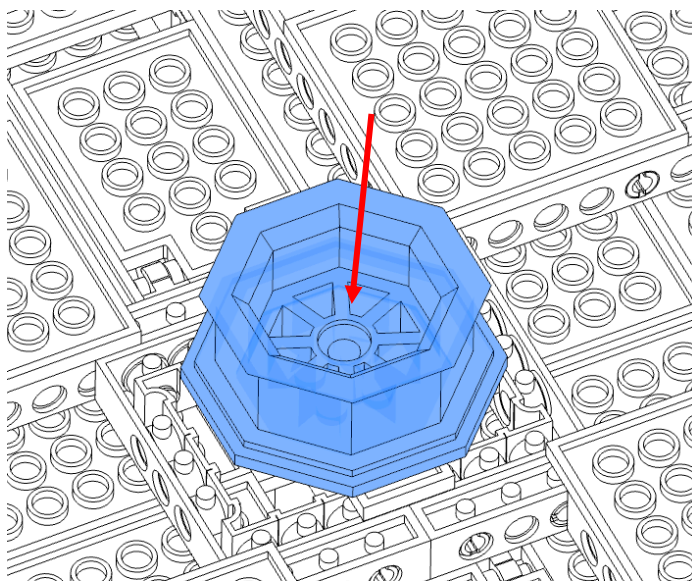
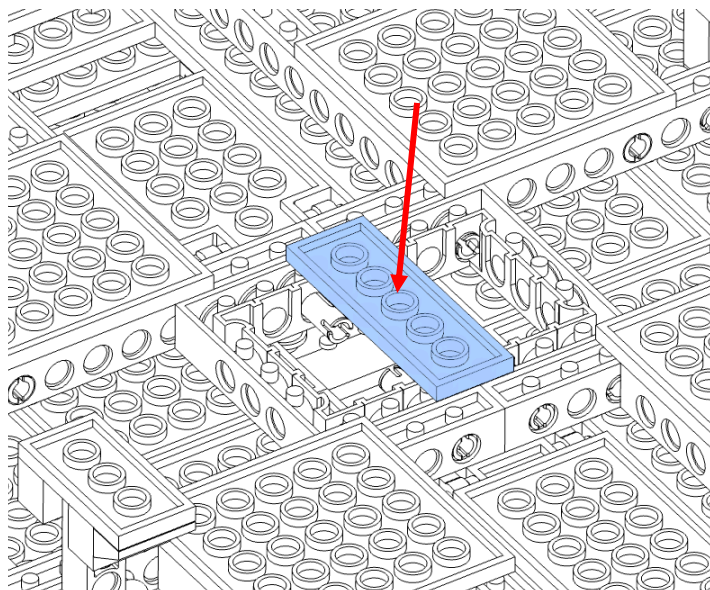

Use the two pins removed previously plus two pins from the bag in the wall mount kit

Wall Mount Instructions Millennium Falcon – (75389, 75257 & 75105)

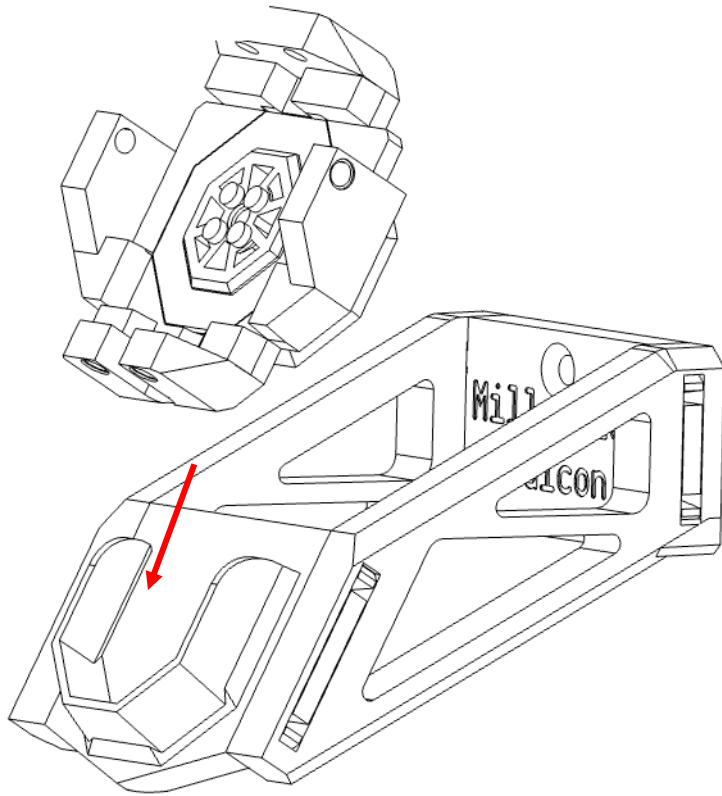

Can be rotated about 8 different angles and then inserted into the slotted plate

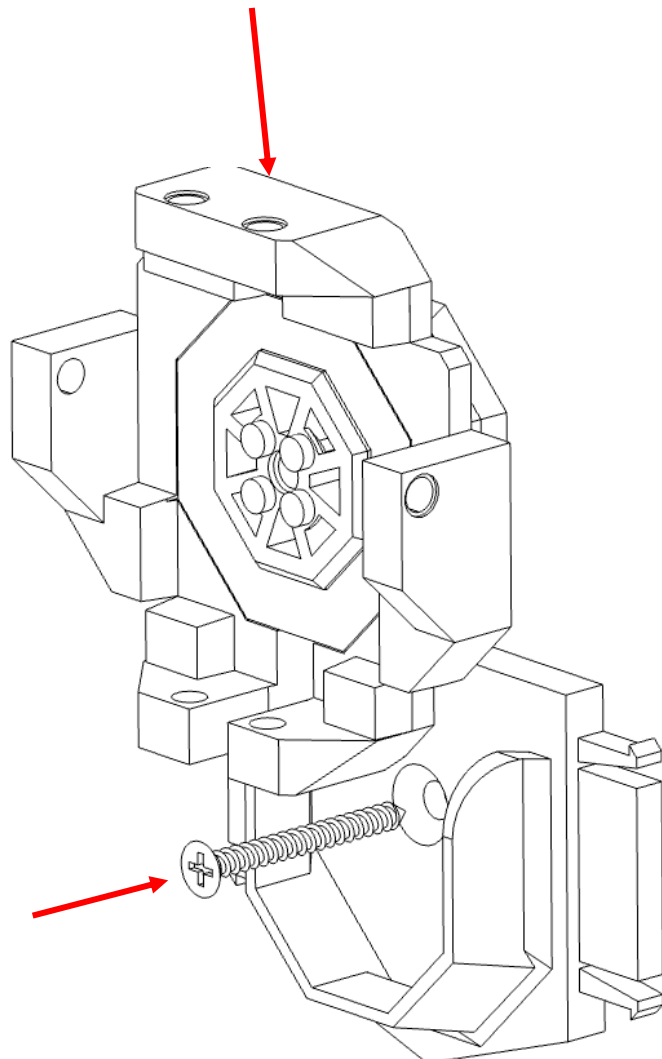

You can also mount the front stretcher directly to the wall for flush to the wall mounting of the set.

Wall Mount Instructions Millennium Falcon – (75389, 75257 & 75105)

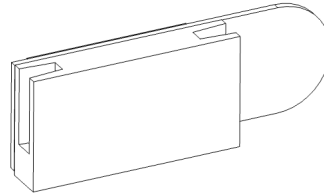
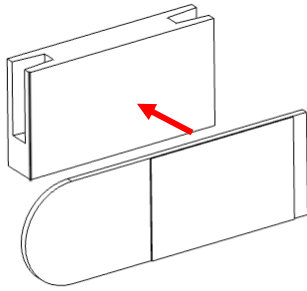

Apply command strip to the cleat. Then secure this to the wall this way up. Finally slid the minifigure mount onto the cleat.

